



'Believe you can'

7<sup>th</sup> September 2020

## **RE: Coronavirus (COVID-19) lockdown measures**

Dear Parents and Carers,

Asalaamalaykum,

Thank you for supporting us to ensure a safe and smooth start to the new school year for all of our pupils.

In light of the ongoing concerns around coronavirus - including the increased lockdown measures in Bolton - please find below a few points as a reminder:

### **Social-distancing:**

Parents are reminded to keep a distance from others **at all times** - including when dropping and collecting children. To assist with this, we have arranged for yellow markers to be painted to the outskirts of the school building. In line with Public Health guidance, you **should not** mix with other households in any setting indoors or outdoors, anywhere. (This does not apply if you are in a support bubble.)

### **Parents congregating:**

We are unable to allow parents to congregate when collecting /dropping off children. Please ensure you drop-off / collect your child promptly and vacate the premises immediately in order to ensure the safety of all concerned.

### **One - way routes:**

Please ensure you are sticking to the one-way routes marked by blue and white signs **at all times**. We have updated our school map and attached it to this letter to outline the different routes.

### **Staggered start / finish times:**

A small number of parents have enquired about the possibility of staggered start / finish times. Given that 30 - 40% of our pupils have siblings in school, we do not consider this to be a viable option as it would lead to parents having to remain on site / at the gates waiting to collect children - causing further congestion. Instead, we have allowed parents to drop the children 10 minutes earlier - from 8:30am - and we will open the school gates from 3:15pm (Mon - Thurs) and 12:15pm on Fridays.

### **Public Transport:**

Only use public transport for essential purposes, which means travel to education, work, and essential appointments only.

We will continue to review our processes and provide further guidance as and when we receive it.

Principal: Mr. H. Asghar  
Adelaide Street, Bolton. BL3 3NY

| T: 01204 322370 | E: [admin@theolivetreeprimary.com](mailto:admin@theolivetreeprimary.com) | W: [www.theolivetreeprimary.com](http://www.theolivetreeprimary.com)

**trust peace fairness respect equality compassion**

Please remember: adherence to Public Health guidance is a collective responsibility for **all** staff, parents and pupils alike. It is **vital** that we work together and support one another in order to ensure the school community remains safe.

Should you have any questions / concerns / suggestions regarding coronavirus, please do not hesitate to email us at: [covidconcerns@theolivetreeprimary.com](mailto:covidconcerns@theolivetreeprimary.com)

Yours sincerely,  
Mr. H. Asghar



Principal  
Enc. Map of school exterior and letter from PHE re increased lockdown measure (Bolton)

### Aerial view of The Olive Tree Primary School with entrances and one-way system marked

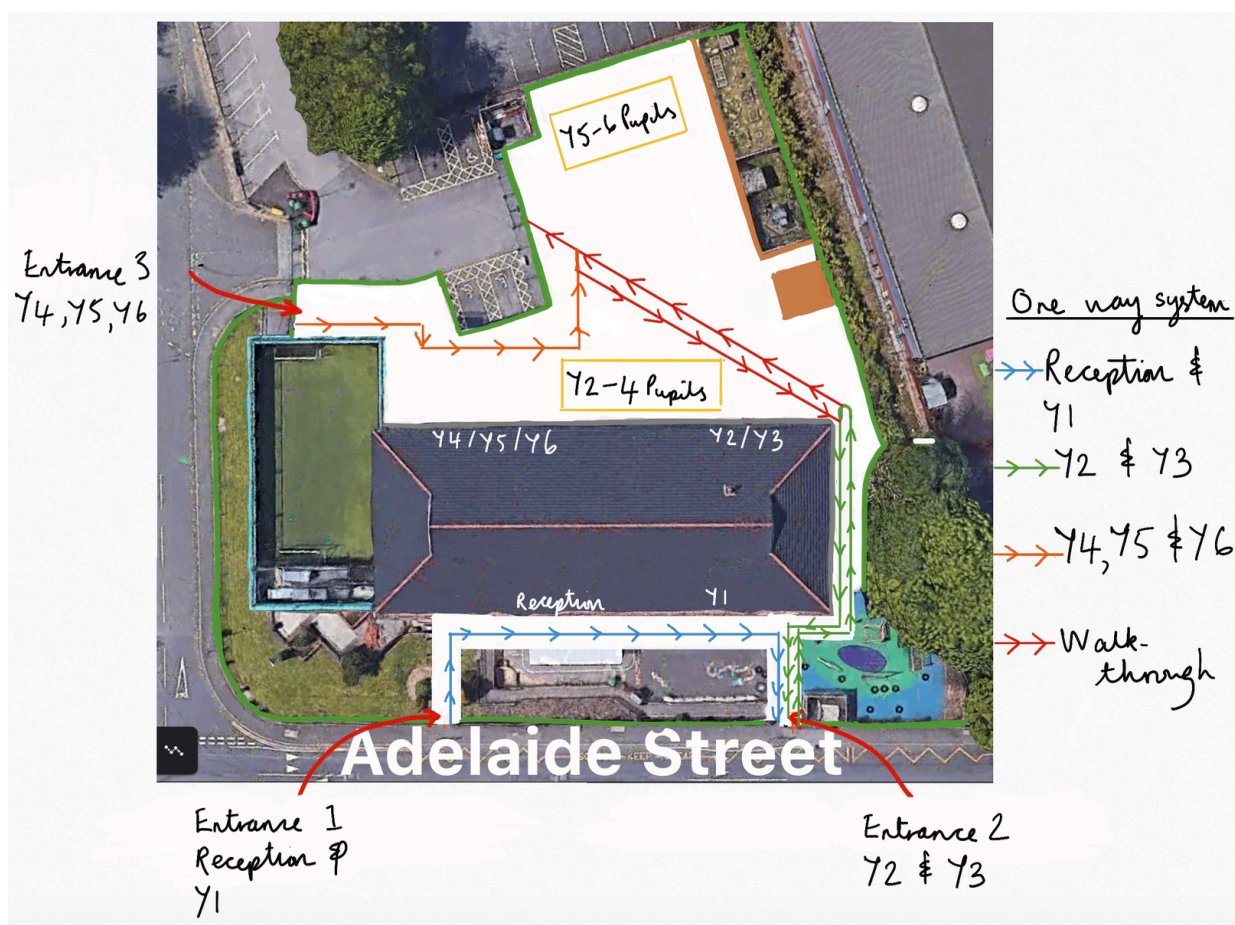

Principal: Mr. H. Asghar  
Adelaide Street, Bolton. BL3 3NY

| T: 01204 322370 | E: [admin@theolivetreeprimary.com](mailto:admin@theolivetreeprimary.com) | W: [www.theolivetreeprimary.com](http://www.theolivetreeprimary.com)

**trust peace fairness respect equality compassion**